

WINCHESTER SERIES - MAPLE

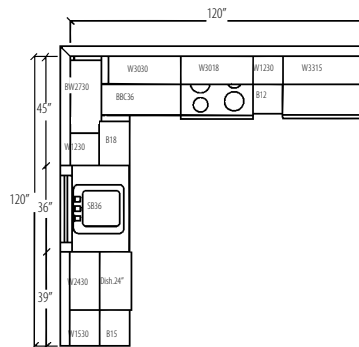

Dovetail Drawer Box



- All wood construction cabinet - **No particle board!**
- Solid maple face frame, doors and drawer fronts!
- Full overlay solid maple raised panel door
- 5/8" plywood box with real wood veneer
- 5/8" plywood full depth shelf with real wood veneer
- **Dovetail, solid wood drawer boxes**
- Steel ball bearing, full extension, **soft-close undermount drawer slides**
- **Six-way adjustable concealed cup hinges**
- Doors are pre-hung on face frame for easy installation
- Easy assembly using wood glue and screwdriver
- Light Carmel Glazed finish



Soft Close Undermount Slides